

# CITY OF SALEM, MASSACHUSETTS DEPARTMENT OF PUBLIC WORKS OLD SALEM JAIL PARKING IMPROVEMENTS

JUNE 21, 2016



KIMBERLEY DRISCOLL, MAYOR

DEPARTMENT OF PUBLIC WORKS

JOHN TOMASZ, DIRECTOR  
DAVID KNOWLTON, PE, TOWN ENGINEER

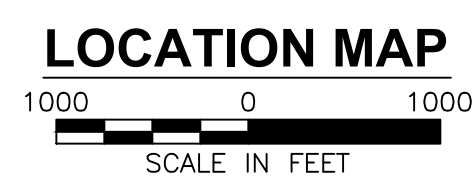

## PLAN INDEX

SHEET NO.	DESCRIPTION
1	COVER SHEET
2	CONSTRUCTION PLAN AND GRADING PLAN
3	LANDSCAPE PLAN
4	CONSTRUCTION DETAILS



www.BETA-Inc.com

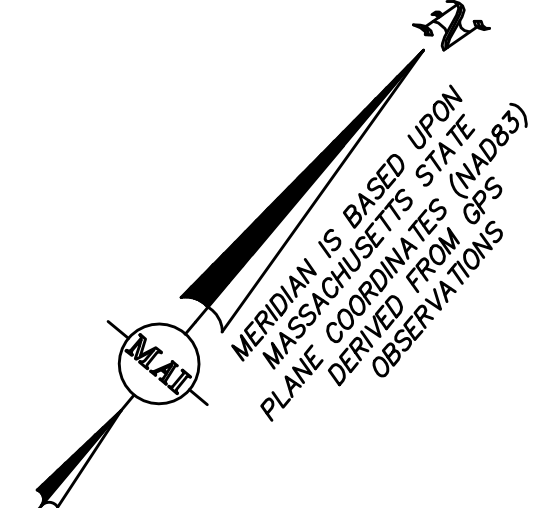

**TREATMENT LEGEND**

- FULL DEPTH BOX WIDENING DRIVEWAY AREA
- PAVEMENT REMOVAL AND REPLACEMENT
- CONCRETE WALK
- STONE DUST WALK

**TEMPORARY BENCHMARK CHART:**

T.B.M.#	DESCRIPTION	ELEVATION
△	DRILL HOLE SET IN CONCRETE WALK	9.16
△	DRILL HOLE SET IN CONCRETE WALK	9.79

(SEE NOTE 3)

**LEGEND:**

- ONE FOOT CONTOUR
- FIVE FOOT CONTOUR
- SPOT ELEVATION
- GRANITE CURB
- CONCRETE
- RETAINING WALL
- ELECTRIC MANHOLE
- MASSACHUSETTS HIGHWAY HANDHOLE
- STREET LIGHT
- FIRE ALARM BOX
- TELEPHONE MANHOLE
- MANHOLE
- SEWER MANHOLE
- DRAIN MANHOLE
- CATCH BASIN
- UNDERGROUND GAS
- PAINT MARKING
- GAS GATE
- WATER GATE
- HYDRANT SIGN
- DETECTABLE WARNING PANEL
- DECIDUOUS TREE
- DRILL HOLE
- TRAFFIC LIGHT
- LANDSCAPE
- SOUTH ESSEX SEWERAGE DISTRICT
- NUMBER OF PARKING SPACES

**ABBREVIATIONS:**

- & AND
- ADJ. ADJUST
- B.O. BY OTHERS
- CB CATCH BASIN
- CEM. CEMENT
- CONC. CONCRETE
- CW CROSSWALK
- EOP EDGE OF PAVEMENT
- EXIST. EXISTING
- FEMA FEDERAL EMERGENCY MANAGEMENT AGENCY
- HC HANDICAPPED
- HMA HOT MIX ASPHALT
- MAX. MAXIMUM
- MIN. MINIMUM
- NO. NUMBER
- O.C. ON-CENTER
- PROP. PROPOSED
- REM. REMOVE
- R&D REMOVE AND DISPOSE
- R&R REMOVE AND RESET
- R&S REMOVE AND STACK
- RW RETAINING WALL
- TYP. TYPICAL

**NOTES:**

- THE TOPOGRAPHY, SITE DETAIL & SURFACE IMPROVEMENTS DEPICTED HEREON WERE OBTAINED FROM AN INSTRUMENT SURVEY CONDUCTED ON THE GROUND BY MERIDIAN ASSOCIATES, INC. ON APRIL 18-19, 2016.
- THIS PLAN DOES NOT SHOW ANY UNRECORDED OR UNWRITTEN EASEMENTS WHICH MAY EXIST. A REASONABLE AND DILIGENT ATTEMPT HAS BEEN MADE TO OBSERVE ANY APPARENT, VISIBLE USES OF THE LAND; HOWEVER, THIS DOES NOT CONSTITUTE A GUARANTEE THAT NO SUCH EASEMENTS EXIST.
- THE ELEVATIONS DEPICTED HEREON WERE BASED ON THE NORTH AMERICAN VERTICAL DATUM OF 1988 (NAVD 88), AS DERIVED FROM GPS OBSERVATIONS.
- THIS PLAN IS NOT TO BE USED FOR THE RECONSTRUCTION OF BOUNDARY LINES OR FOR TITLE INSURANCE PURPOSES. RIGHT OF WAY AND BOUNDARY LINES DEPICTED HEREON ARE APPROXIMATE ONLY. MAI DID NOT PERFORM A BOUNDARY RETRACEMENT SURVEY.
- FIELD SURVEY EVIDENCED REMAINS OF DIG SAFE PAINT LINES IN THIS AREA. MOST ARE UNIDENTIFIABLE.
- THE LOCATION OF UNDERGROUND UTILITIES ARE NOT DEPICTED HEREON.
- BASED UPON FEMA FLOOD INSURANCE RATE MAP NUMBER 25009C0419G DATED JULY 16, 2014 A PORTION OF THE PREMISES IS LOCATED IN FLOOD ZONE AE (ELEVATION=10 NAVD88), AREAS SUBJECT TO INUNDATION BY THE 1% ANNUAL CHANCE FLOOD EVENT DETERMINED BY DETAILED METHODS. BASE FLOOD ELEVATIONS ARE SHOWN WITHIN THESE ZONES.
- DISTURBED AREAS TO BE LOAMED AND SEEDDED.
- CONTRACTOR SHALL MAKE EFFORTS TO NOT IMPACT, DAMAGE, OR DESTROY EXISTING RETAINING WALL ASSOCIATED WITH HOWARD STREET CEMETERY. THE CONTRACTOR SHALL RESTORE ANY DISTURBED PORTIONS OF THE RETAINING WALL IMPACTED BY CONSTRUCTION AT NO ADDITIONAL COST TO THE CITY OF SALEM.
- DETECTABLE PANELS SHALL COMPLY WITH MASSDOT E 107.6.5R.

THE LOCATION OF UNDERGROUND UTILITIES ARE NOT DEPICTED. THE CONTRACTOR, PRIOR TO COMMENCEMENT OF CONSTRUCTION, SHALL VERIFY THE LOCATION OF ALL UTILITIES AND CONTACT DIG SAFE AT 1-888-344-7233.

Curve Table				
Curve #	Delta	Radius	Length	TANGENT
C1	35°44'20"	25.00	15.59	8.06
C2	33°34'24"	25.00	14.65	7.54
C3	56°21'03"	47.50	46.72	25.44
C4	120°15'00"	1.25	2.62	2.18
C5	60°09'12"	1.25	1.31	0.72
C6	120°00'40"	1.25	2.62	2.17
C7	59°59'20"	1.25	1.31	0.72
C8	56°29'56"	12.02	11.85	6.46
C9	51°13'56"	33.00	29.51	15.82
C10	51°10'08"	40.50	36.17	19.39
C11	16°08'55"	33.00	9.30	4.68
C12	9°35'28"	39.00	6.53	3.27

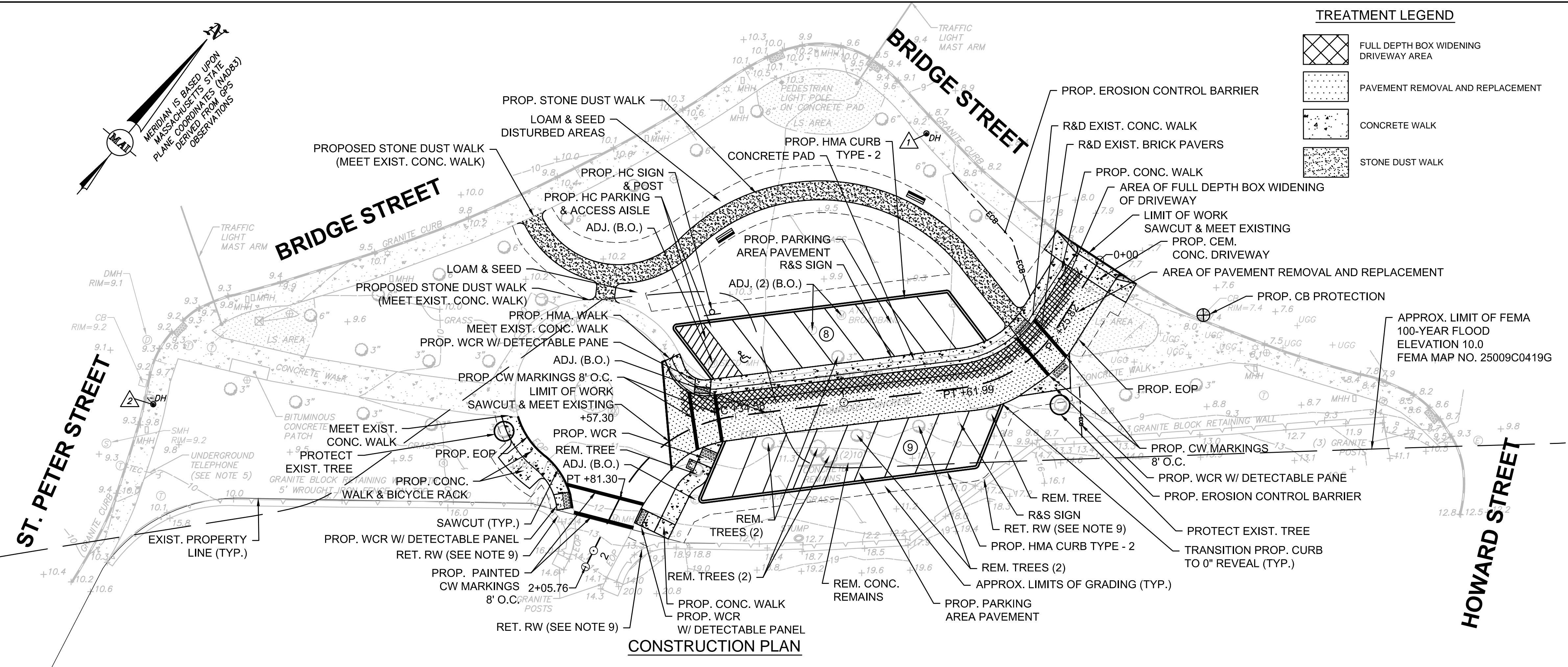

**CONSTRUCTION PLAN**

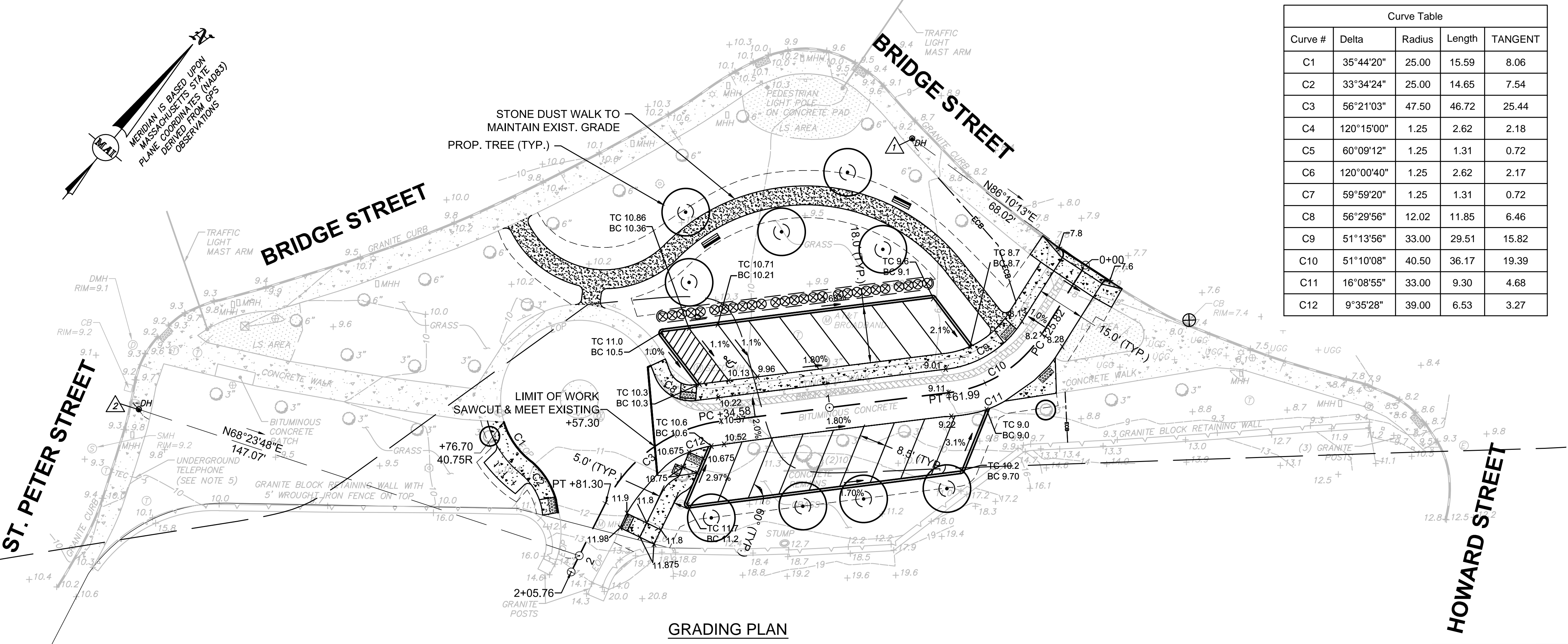

**GRADING PLAN**

0:\4605\4603 - SALEM ON CALL\ADMIN\TASK 4 - PARKING LOT\DRAWING FILES\PLAN SET\CONSTRUCTION PLANS\DWG

NUMBER	DATE	MADE BY	CHECKED BY	DESCRIPTION
REVISIONS				

DRAWN BY: CRL  
 DESIGNED BY: MJT  
 CHECKED BY: KP

PE STAMP:  
**For Review Only**  
**BETA**  
 www.BETA-inc.com

PREPARED BY:

SCALE:  
  
 SCALE IN FEET: 1"=20'

**OLD SALEM JAIL PARKING IMPROVEMENTS**  
**SALEM, MASSACHUSETTS**  
**CONSTRUCTION PLAN**  
**AND GRADING PLAN**

BETA JOB No. 4563 - 5  
 PLOT DATE: 6/21/2016 3:38 PM  
 ISSUE DATE: 4/27/2016 4:21 PM  
 SHEET No. 2 OF 4  
 File: Construction Plan.dwg

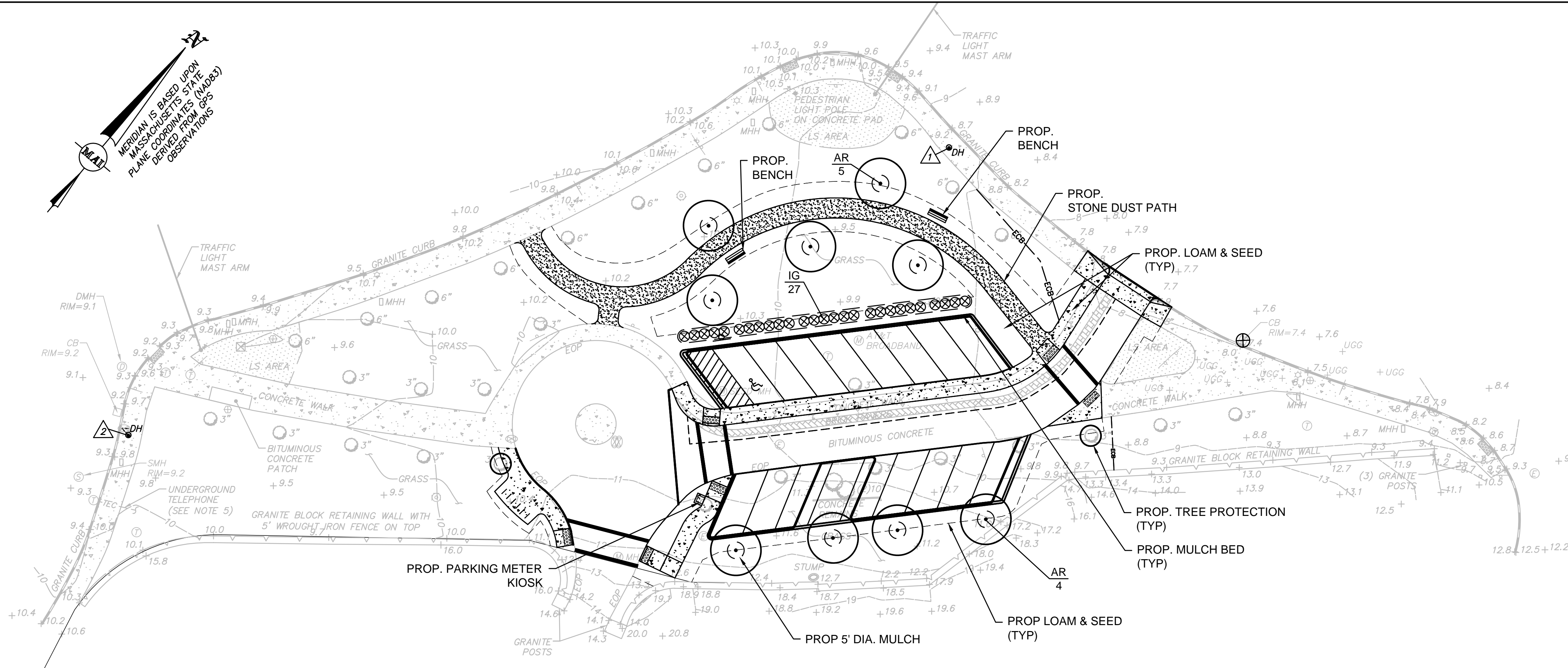
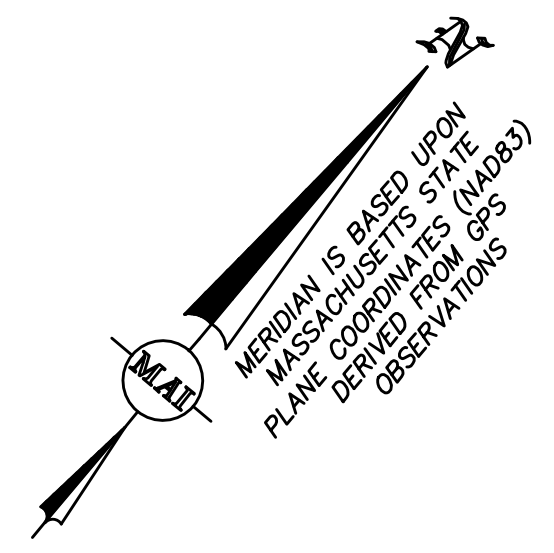

- LANDSCAPE NOTES:**
1. NO PLANT MATERIALS SHALL BE INSTALLED UNTIL ALL GRADING AND CONSTRUCTION HAS BEEN COMPLETED IN THE IMMEDIATE AREA.
  2. ALL TREES SHALL BE BALLED AND BURLAPPED, UNLESS OTHERWISE NOTED, OR APPROVED BY THE ENGINEER.
  3. EXCAVATE TO REQUIRED DEPTH FOR ROOTBALL OR AS SHOWN ON THE DETAILS AND BACKFILL WITH PLANTING MIX
  4. 3" DEEP PINE BARK MULCH SHALL BE INSTALLED UNDER ALL NEW TREES, SHRUBS, AND VINES, AS SHOWN ON THE PLANS, OR AS REQUIRED BY ENGINEER.
  5. RAISE AND REPLANT AND TREE OR SHRUB THAT SETTLES MORE THAN 3 INCHES AFTER PLANTING AND WATERING IN.
  6. WATER, BY FLOODING, TWICE IN THE FIRST TWO HOURS AFTER PLANTING.
  7. FINAL QUANTITY FOR EACH PLANT TYPE SHALL BE AS SHOWN ON THE PLAN. THIS NUMBER SHALL TAKE PRECEDENCE IN CASE OF ANY DISCREPANCY BETWEEN QUANTITIES SHOWN ON THE PLANT LIST AND ON THE PLAN.
  8. ANY PROPOSED PLANT SUBSTITUTIONS MUST BE APPROVED IN WRITING BY THE ENGINEER PRIOR TO THE START OF WORK.
  9. ALL PLANT MATERIALS SHALL BE GUARANTEED FOR ONE YEAR FOLLOWING DATE OF FINAL ACCEPTANCE.
  10. EXISTING TREES TO REMAIN SHALL BE PROTECTED WITH TEMPORARY SNOW FENCE AS DIRECTED BY THE ENGINEER AND AS SHOWN ON THE PLANS. ERECT SNOW FENCE AT THE DRIP LINE OF THE TREE. CONTRACTOR SHALL NOT STORE VEHICLES OR MATERIALS WITHIN THE LANDSCAPE AREAS. ANY DAMAGE TO EXISTING TREES, SHRUBS, OR LAWNS SHALL BE REPAIRED BY THE CONTRACTOR AT NO ADDITIONAL COST TO THE DEPARTMENT.

KEY	QUAN.	BOTANICAL NAME	COMMON NAME	SIZE	ROOT	NOTES
AR	9	ACER RUBRUM 'ARMSTRONG'	MAPLE - RED - ARMSTRONG	2-2.5" CAL	B&B	
IG	27	ILEX GLABRA 'DENSE'	INKBERRY - COMPACT - 'DENSE'	24 - 30"	CONT.	3 GAL. 2.5' O.C.

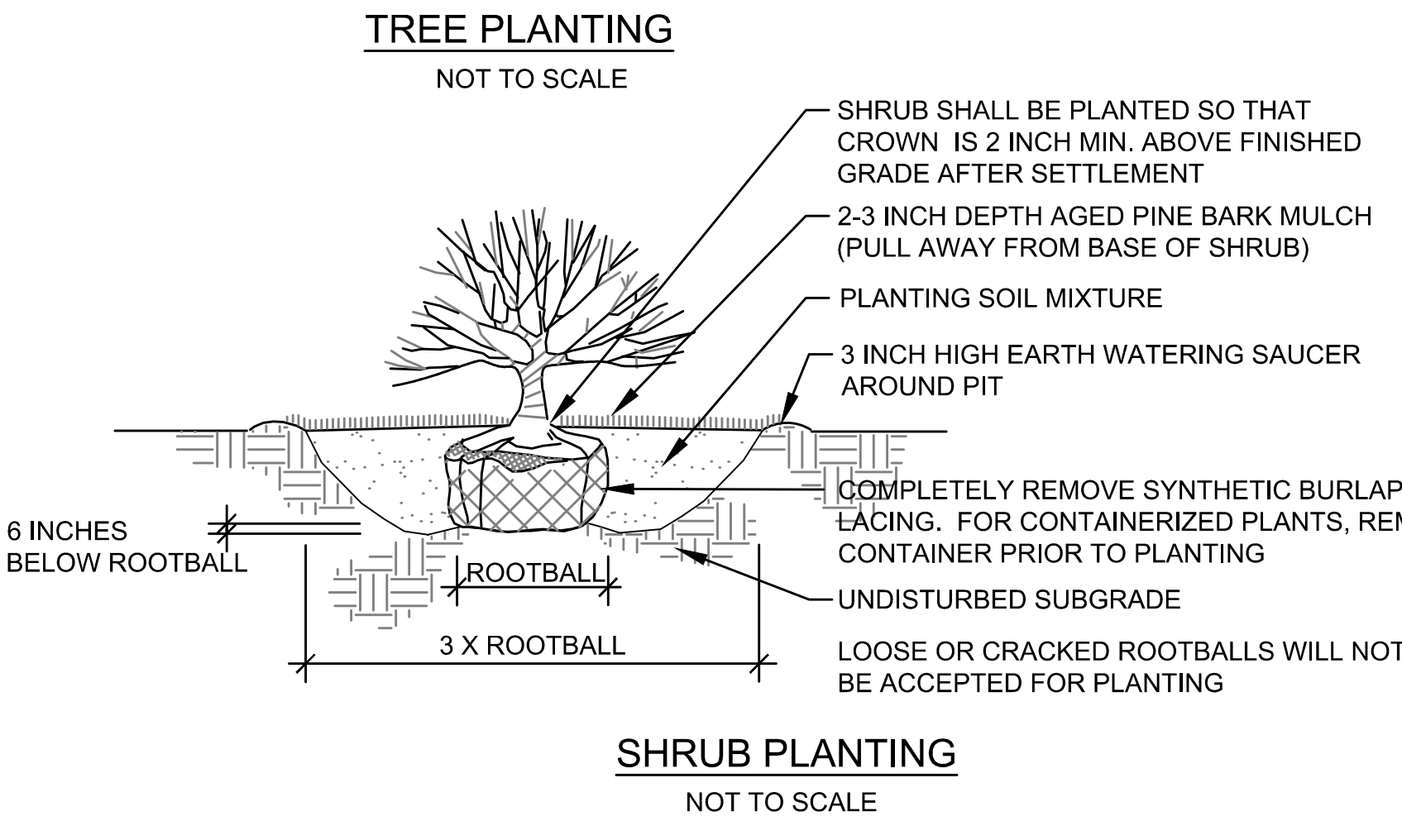
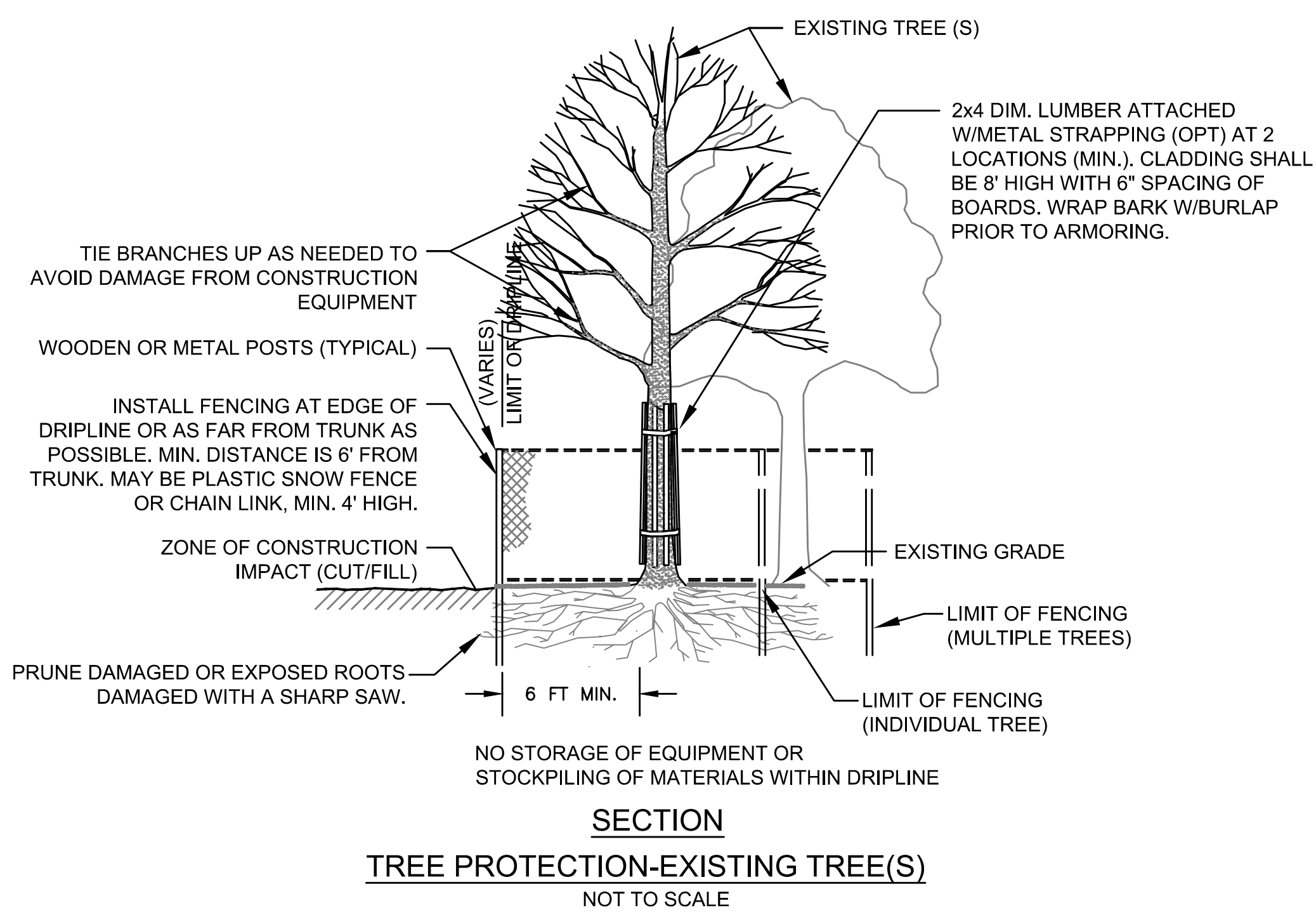
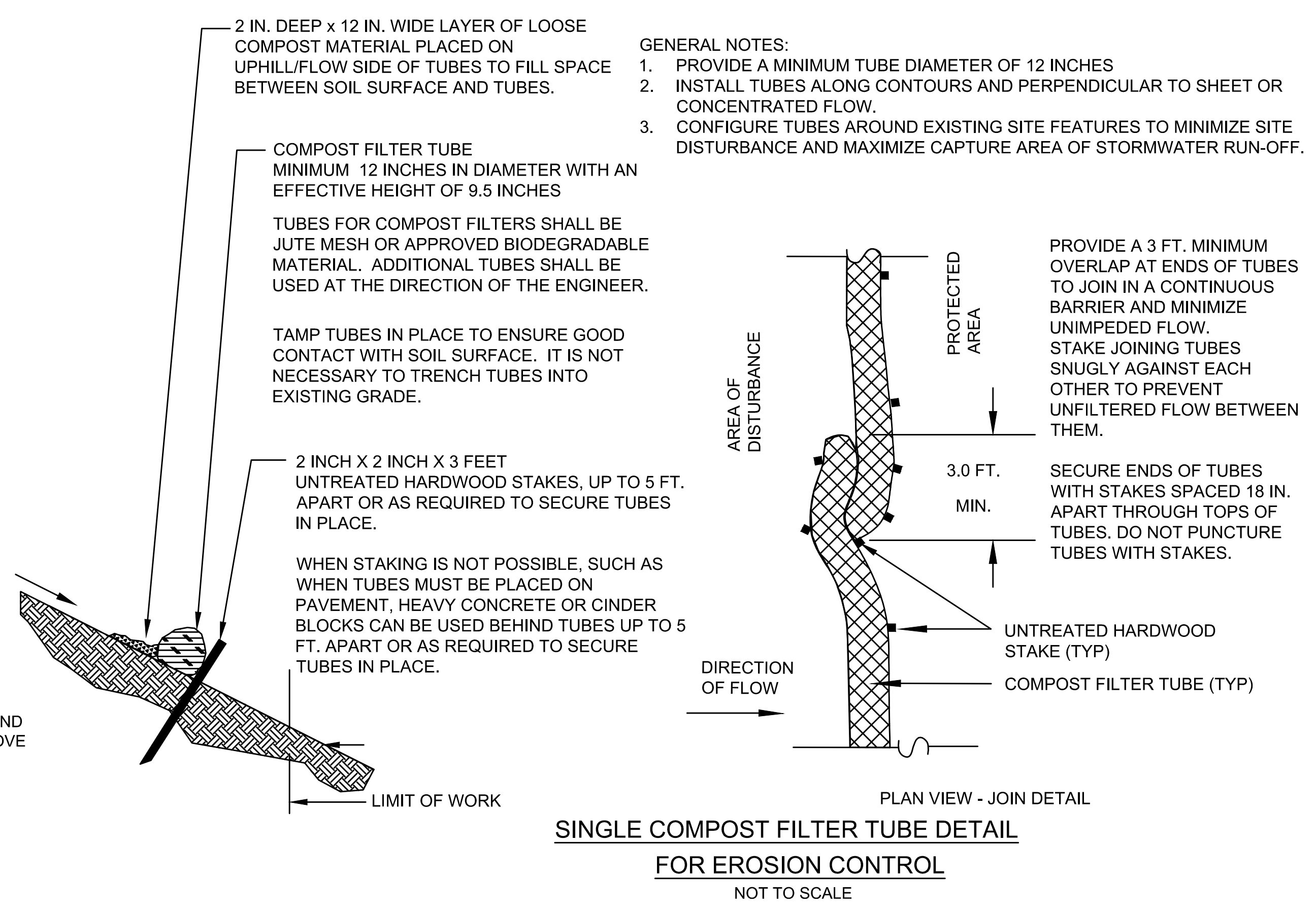
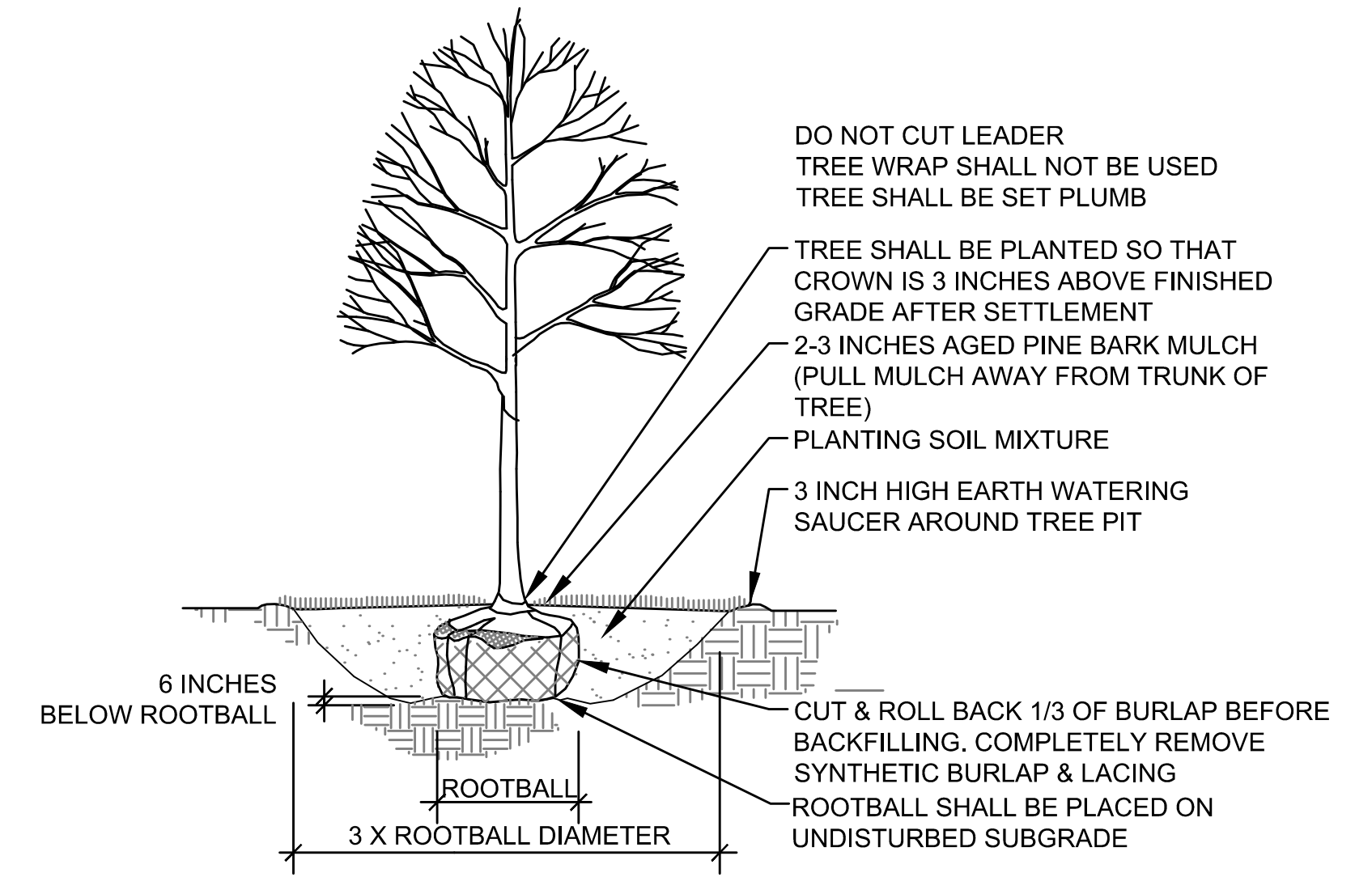
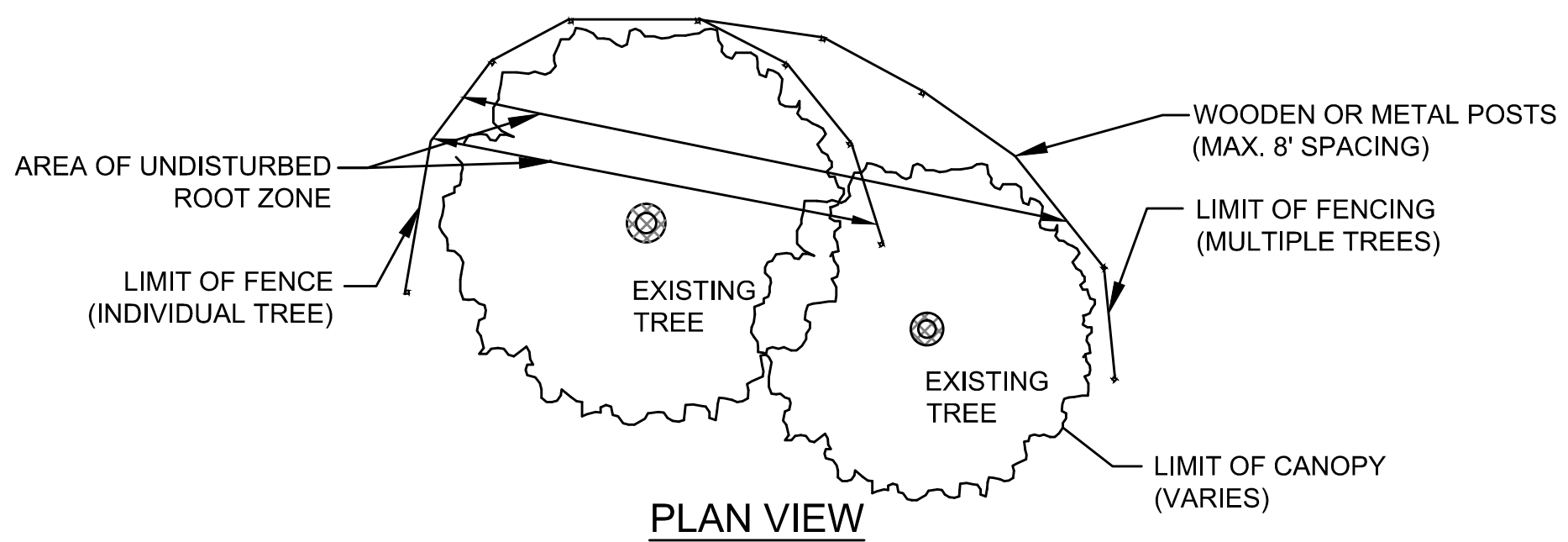

0:\60504683 - SALEM ON CALL\ADMIN\TASK 4 - PARKING LOT\DRAWING FILES\PLAN SET\LANDSCAPE PLAN.DWG

NUMBER	DATE	MADE BY	CHECKED BY	DESCRIPTION
REVISIONS				

DRAWN BY:  
CRL  
DESIGNED BY:  
MJT  
CHECKED BY:  
KP

PE STAMP:  
**For Review Only**

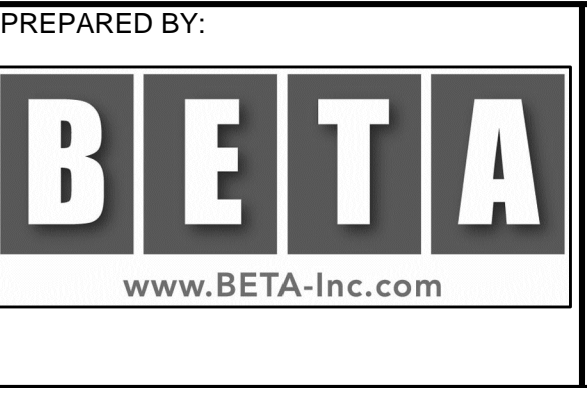

PREPARED BY:  
SCALE:  
20 0 20 40  
SCALE IN FEET: 1"=20'

UNLESS OTHERWISE NOTED OR CHANGED BY REPRODUCTION

**OLD SALEM JAIL PARKING IMPROVEMENTS  
SALEM, MASSACHUSETTS**  
  
LANDSCAPING AND  
SITE IMPROVEMENTS PLAN

BETA JOB No. 4563 - 5  
PLOT DATE: 6/21/2016 2:52 PM  
ISSUE DATE: 5/2/2016 3:43 PM  
SHEET No. 3 OF 4  
File:

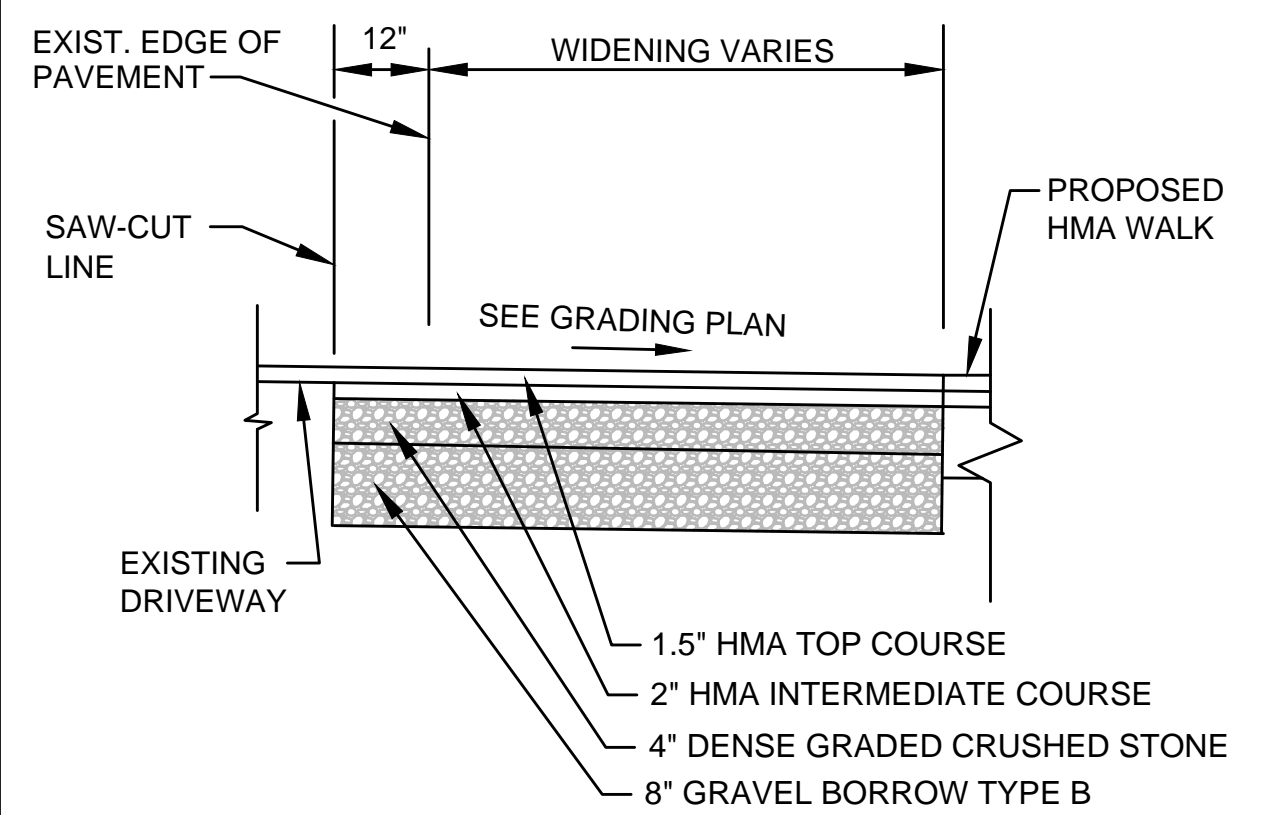

**FULL DEPTH BOX WIDENING OF DRIVEWAY**  
NOT TO SCALE

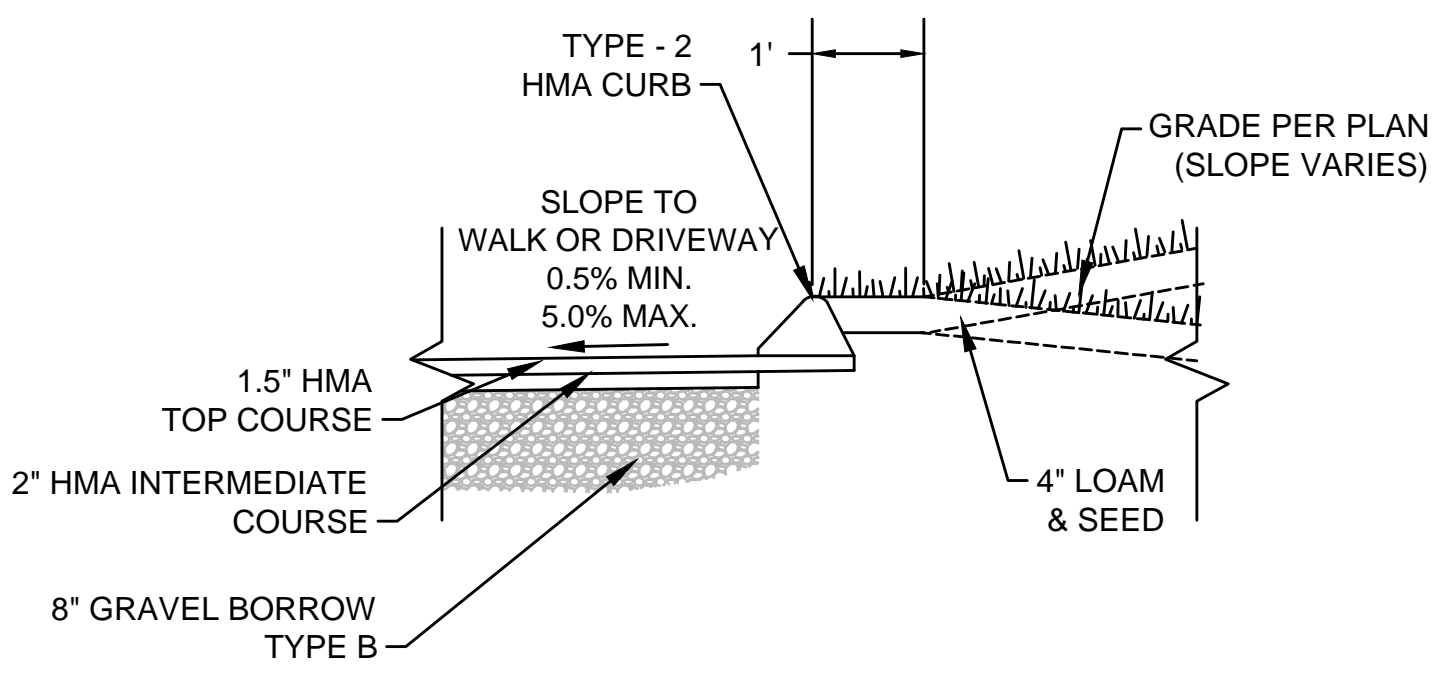

**PARKING PAVEMENT DETAIL**  
NOT TO SCALE

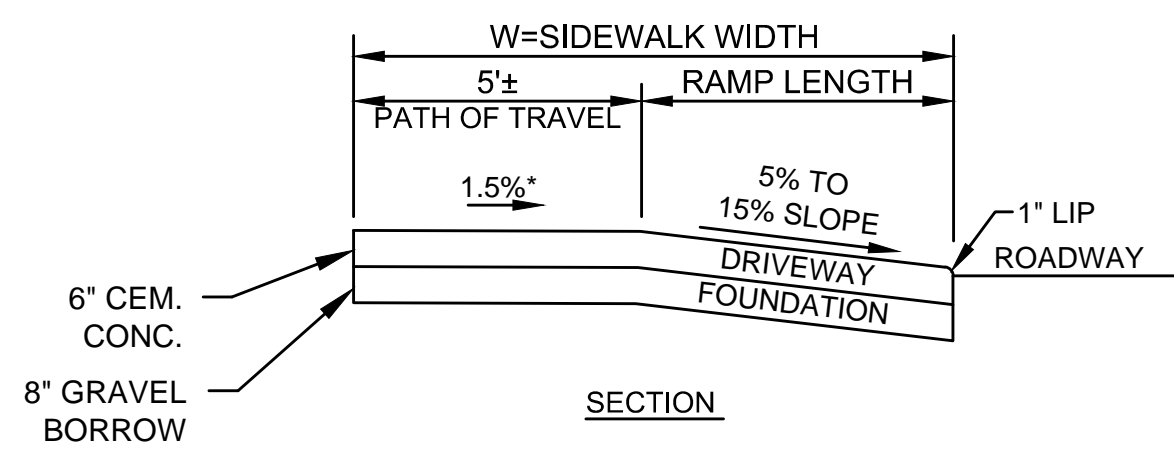

**CONCRETE DRIVEWAY**  
NOT TO SCALE

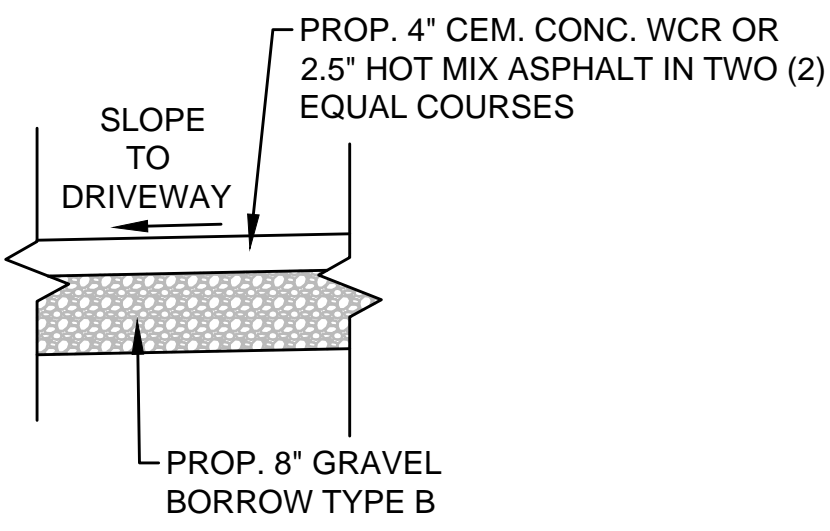
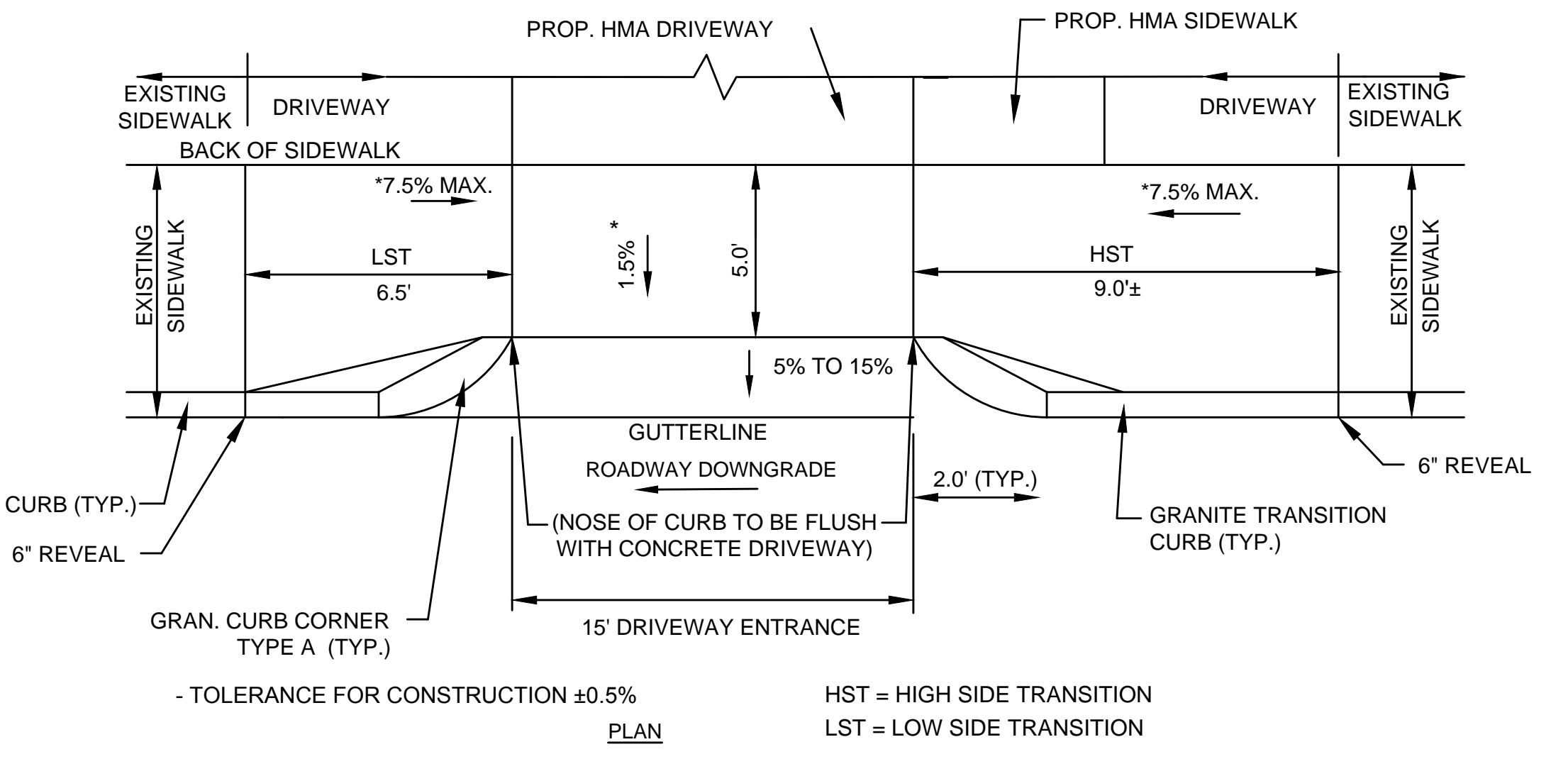

**HMA WALK / CONCRETE WCR / CONCRETE PAD / CONCRETE WALK**  
NOT TO SCALE

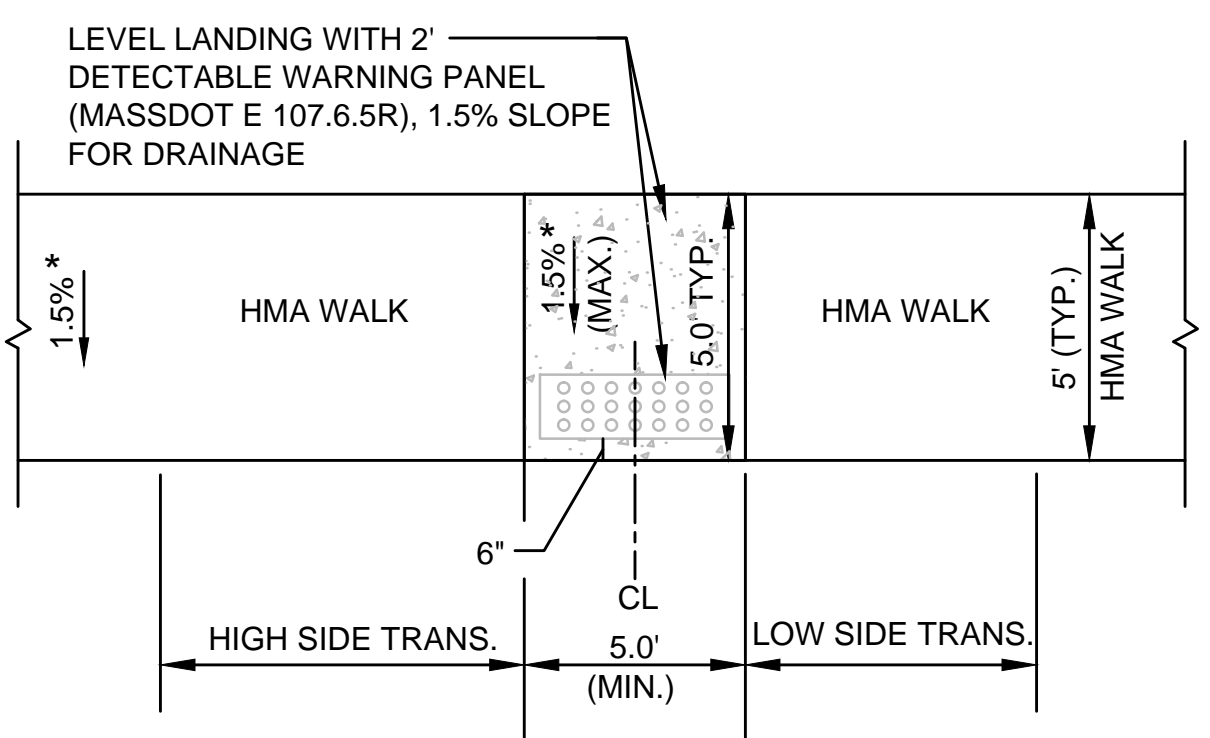

**WHEELCHAIR RAMP (WCR)**  
NOT TO SCALE

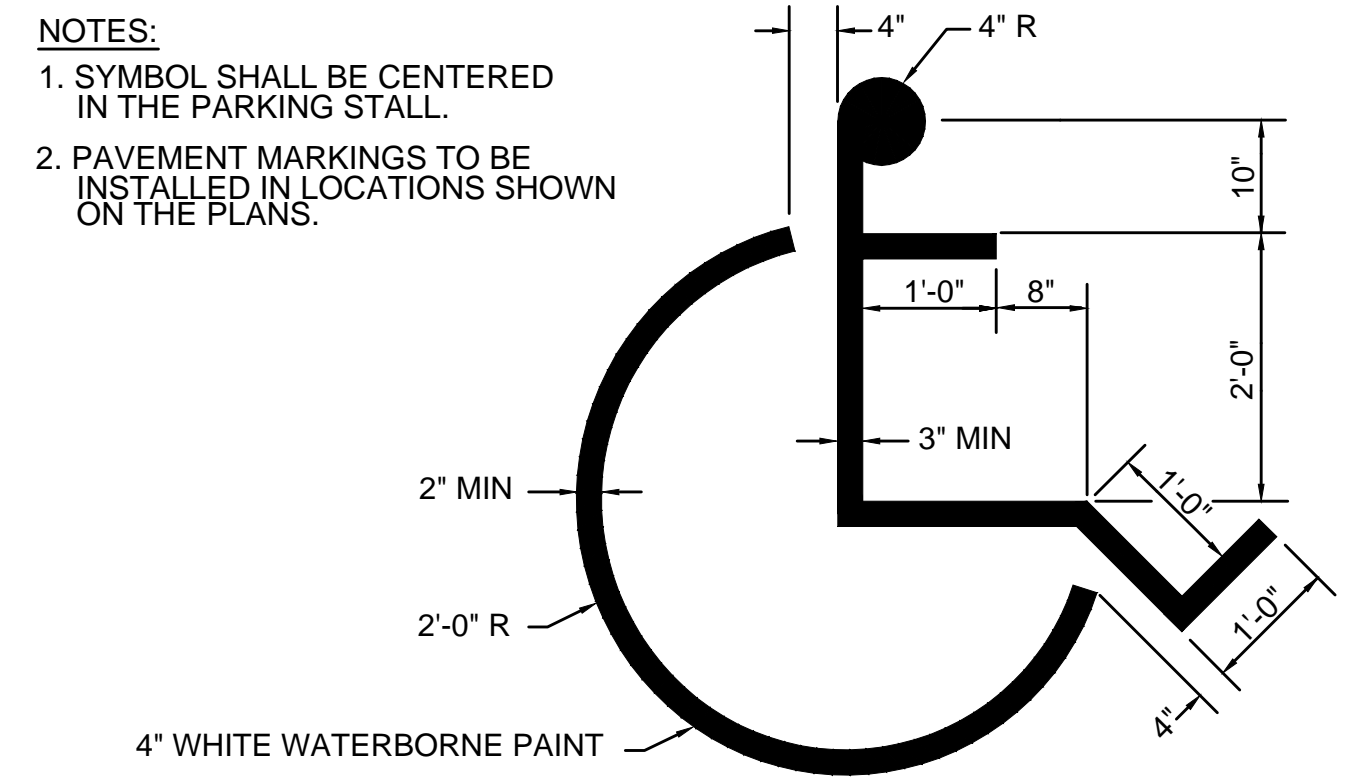

**HANDICAP PARKING SYMBOL**  
NOT TO SCALE

NOTES:  
1. SYMBOL SHALL BE CENTERED IN THE PARKING STALL.  
2. PAVEMENT MARKINGS TO BE INSTALLED IN LOCATIONS SHOWN ON THE PLANS.

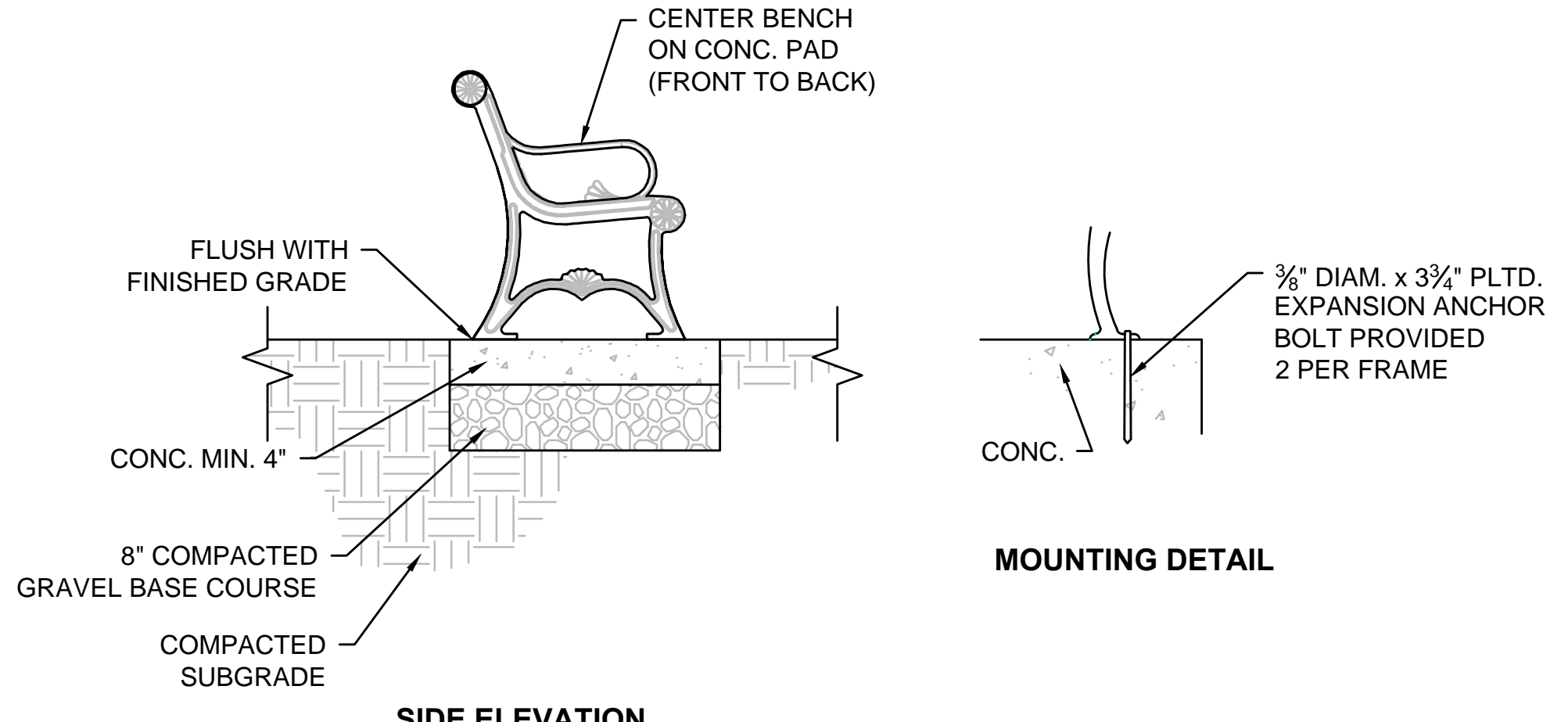

**MOUNTING DETAIL**

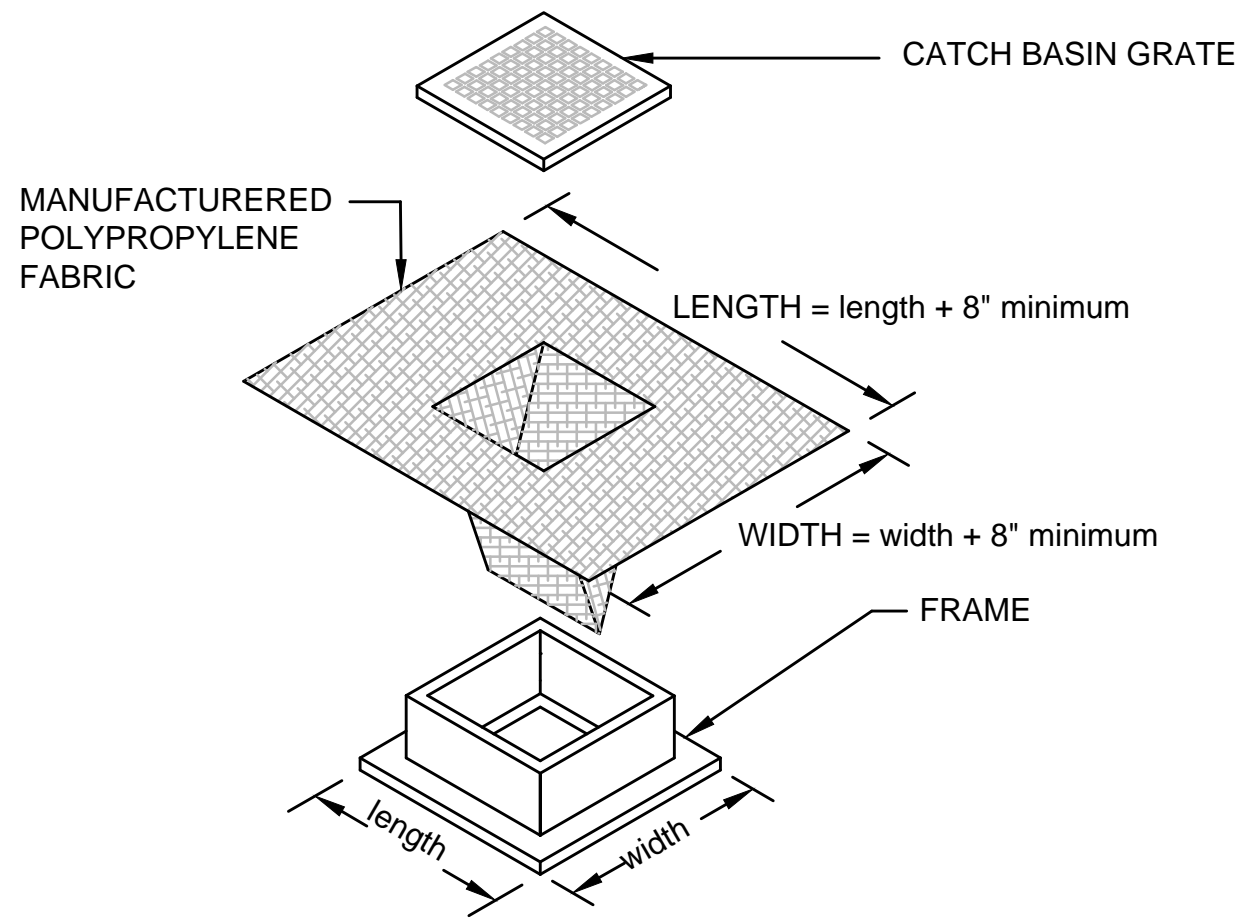

NOTES:  
1. LENGTH AND WIDTH OF POLYPROPYLENE FABRIC MUST EXCEED EXISTING CATCH BASIN FRAME DIMENSIONS BY A MINIMUM OF 8\"/>  
2. REMOVE CATCH BASIN GRATE AND INSTALL POLYPROPYLENE FABRIC OVER CATCH BASIN FRAME. REPLACE CATCH BASIN GRATE TO SECURE POLYPROPYLENE FABRIC IN PLACE.  
3. CATCH BASIN EROSION CONTROL TO BE PLACED AT ALL CATCH BASIN WITHIN PROJECT LIMITS.

**CATCH BASIN EROSION CONTROL PROTECTION - SILT SACK**  
NOT TO SCALE

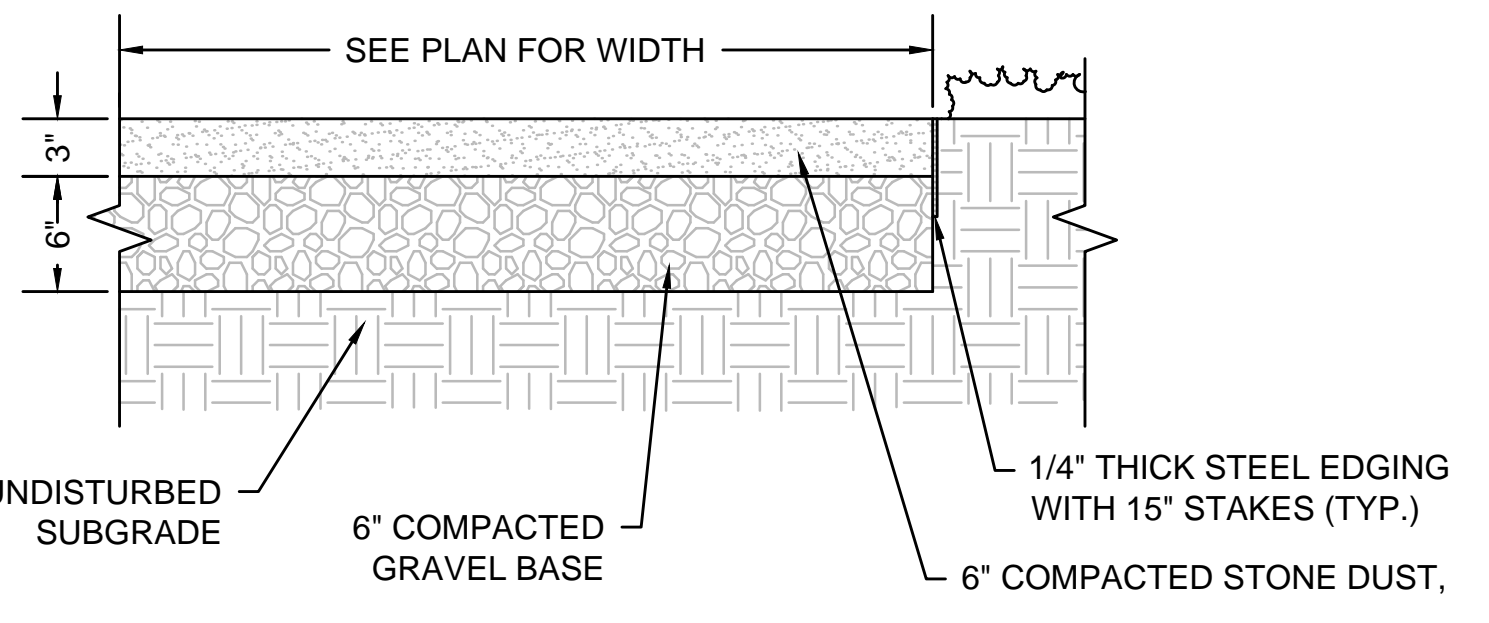

**STONE DUST PATH**  
NOT TO SCALE

TABLE I	
PROFILE GRADE	HIGH SIDE TRANSITION LENGTH FOR 7.5% DESIGN SLOPE (FEET)
0	6'-6"
>0-1	7'-8"
>1-2	9'-0"
>2-3	11'-0"
>3-4	14'-0"
>4	15'-0" MAX.

**WHEELCHAIR RAMP (WCR) HIGH SIDE TRANSITION LENGTHS**  
FIGURES ARE BASED ON A DESIGN SLOPE OF 7.5% AND A REVEAL OF 6\"/>

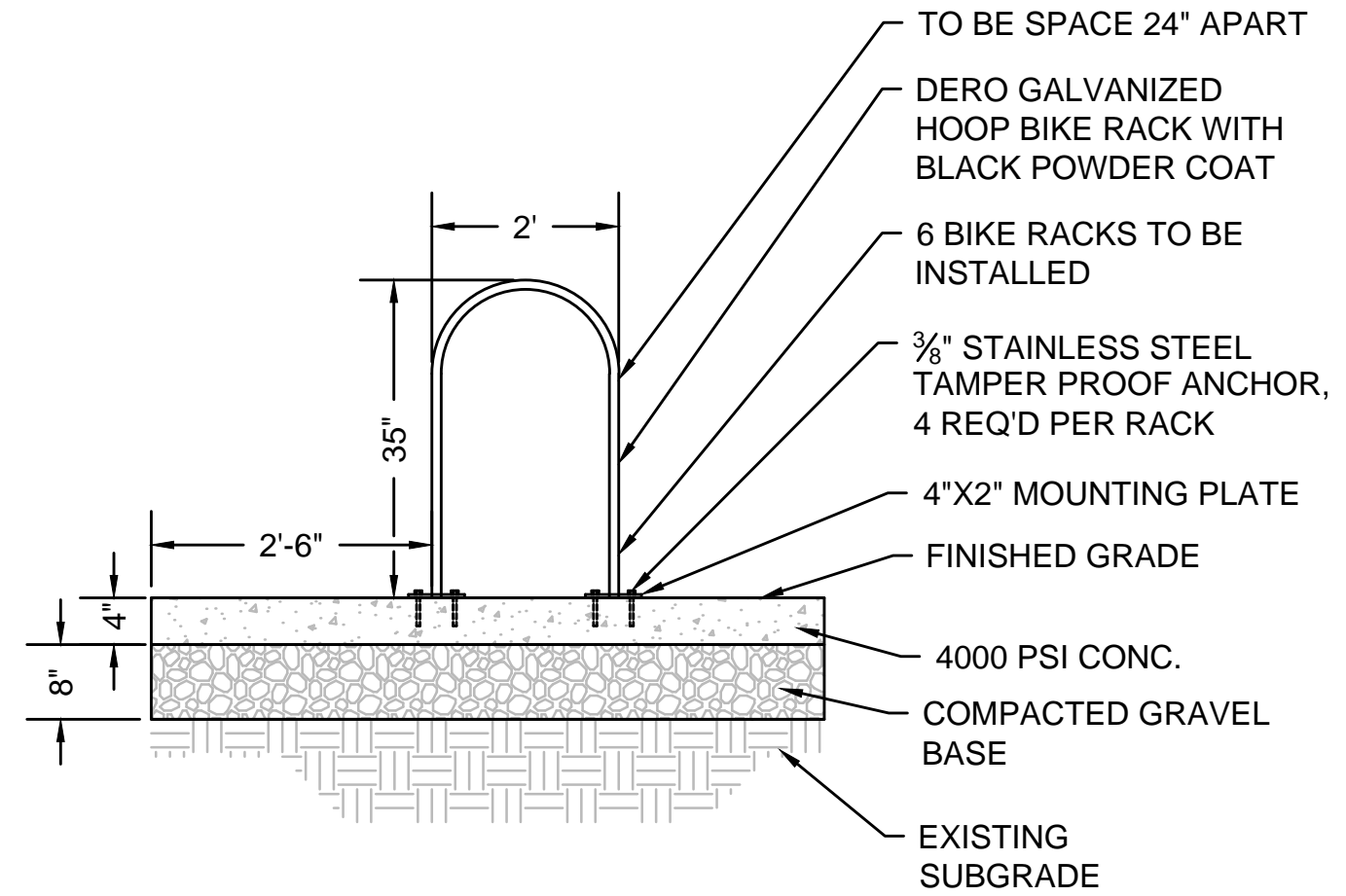

**BIKE RACK**  
NOT TO SCALE

NOTE:  
1. CONTRACTOR SHALL FOLLOW MANUFACTURER'S INSTALLATION REQUIREMENTS.

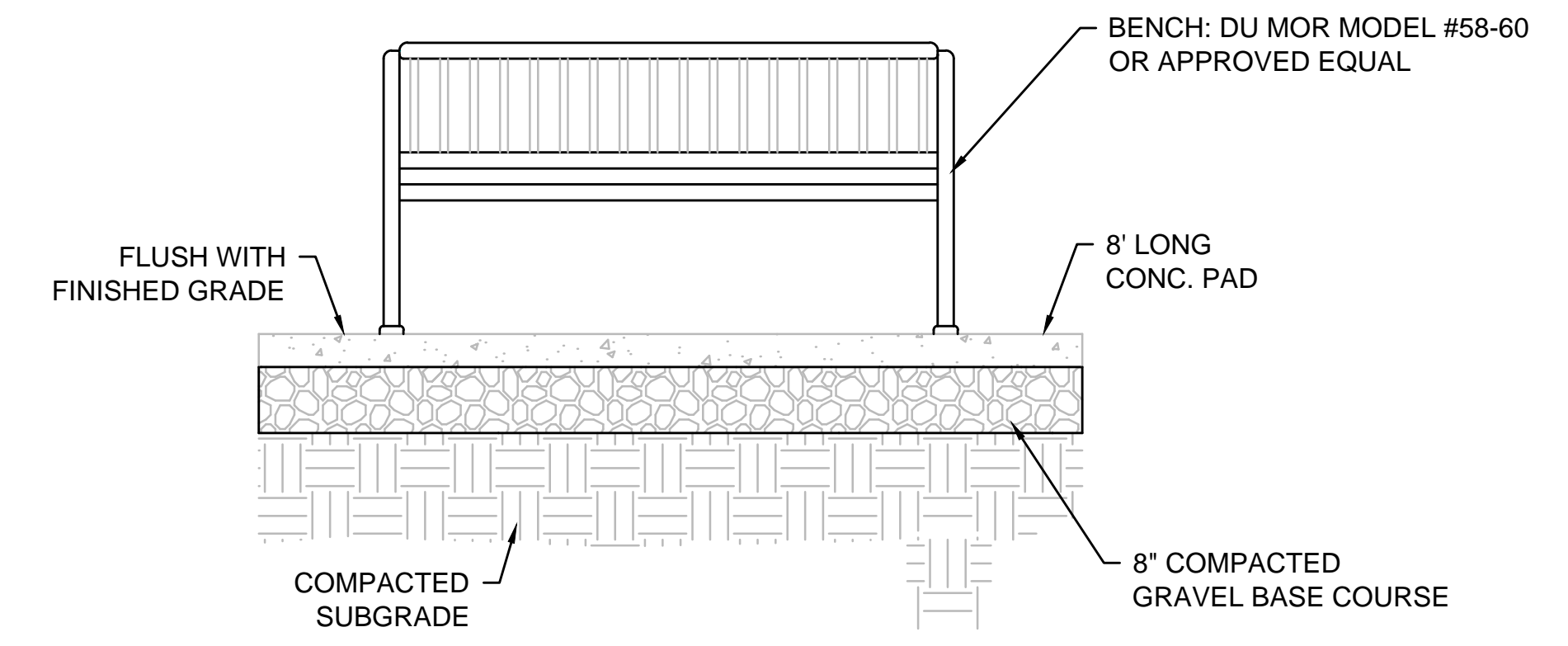

**REAR ELEVATION**

NOTES:  
1. BENCHES SHALL BE MOUNTED AT LOCATION SHOWN ON PLAN WITH MANUFACTURER'S MOUNTING KIT.  
2. INSTALLATION TO BE COMPLETED IN ACCORDANCE WITH MANUFACTURER'S SPECIFICATIONS.

**BENCH DETAIL**  
NOT TO SCALE

0:\4605\4603 - SALEM ON CALL\ADMIN\TASK 4 - PARKING LOT\DRAWING FILES\PLAN SET\DETAILS.DWG

NUMBER	DATE	MADE BY	CHECKED BY	DESCRIPTION
REVISIONS				

DRAWN BY:  
CRL  
DESIGNED BY:  
MJT  
CHECKED BY:  
KP

PE STAMP:  
**For Review Only**



PREPARED BY:  
SCALE:  
20 0 20 40  
SCALE IN FEET: 1"=20'

UNLESS OTHERWISE NOTED OR CHANGED BY REPRODUCTION

**OLD SALEM JAIL PARKING IMPROVEMENTS**  
**SALEM, MASSACHUSETTS**  
**CONSTRUCTION DETAILS**

BETA JOB No. 4563 - 5  
PLOT DATE: 6/21/2016 3:02 PM  
ISSUE DATE: 5/3/2016 8:26 AM  
SHEET No. **4 OF 4**  
File: